



#1

An example of a clear iconic grab bar illustration. Would a hand on the bar help clarify the icon? Or, a reverse background make it pop?



#2

The photo of the bar, clearly shows clearly w/o a hand, the angle of the bar, gives it nice depth. The words seem a bit disconnected from the photo. I like the shadowing on the font. And the background red helps the text jump out.



#3

I like the Icon, and the white on dark, the bar itself is looks more like a dumbbell, them a grab bar.

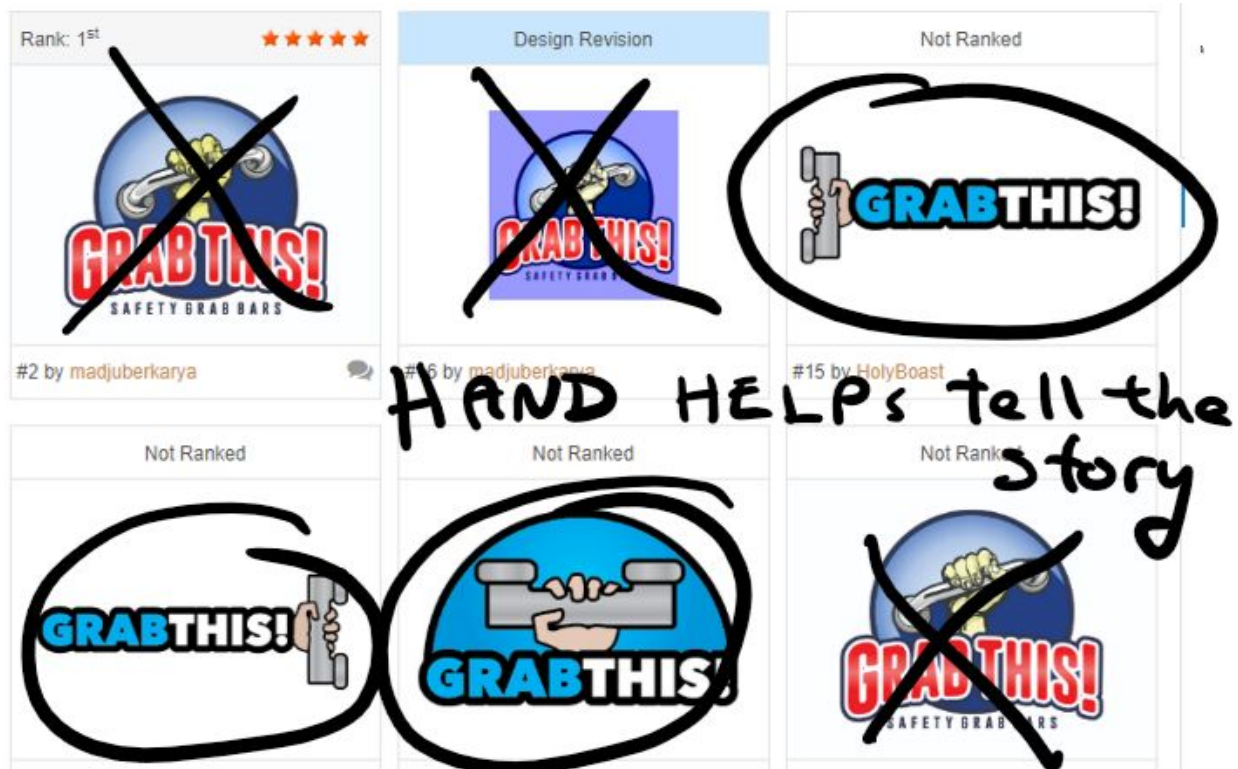

#4

Hand located on the grab bar helps me identify, that it is a “grab” bar. Do not like these colors, or the font. It is a bit too “cartoon” like.



#5

Grab bar icon is clean, and reinforces the brand. No hand here, seems OK to me.



#6

Hand shown on the bar, this help reinforce the name. Woman's hand is a nice touch. Bathrobe is homey. I do not like the font.